

# LP NOVACORE™ THERMAL INSULATED SHEATHING: CORNERS 101

## Outside corners:

Install the 1st panel to within an 1/8" of the edge of the corner end stud. Install the 2nd panel to overlap so that the edge of the 2nd panel is flush with the outer face of the OSB from the 1st panel. Alternatively, the foam of the 2nd panel may be trimmed and the 1st panel shifted to cover the foam of the 2nd panel (leave an 1/8" gap). Note that nails will be approximately 2" from the corner depending on the detail. (see below)

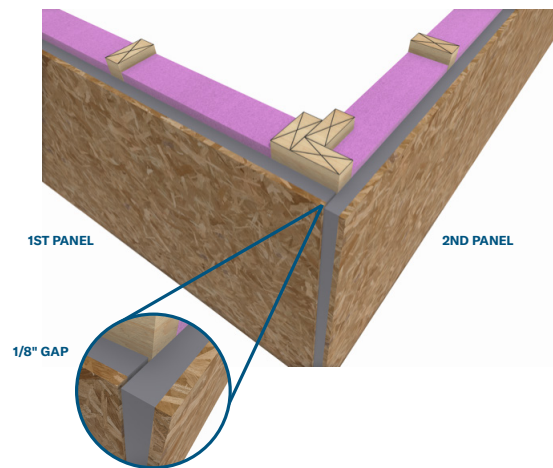
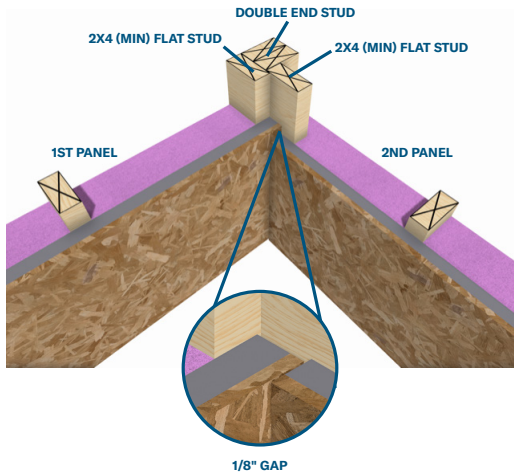

## Inside corners:

Install the 1st panel into the flat stud of the connecting wall (leave an 1/8" gap). Install the 2nd panel from the other side to leave an 1/8" gap with the 1st panel. Two options are shown. The details shown assume 2x4 wall framing. Adjust as needed for 2x6 or larger wall framing. (see below)

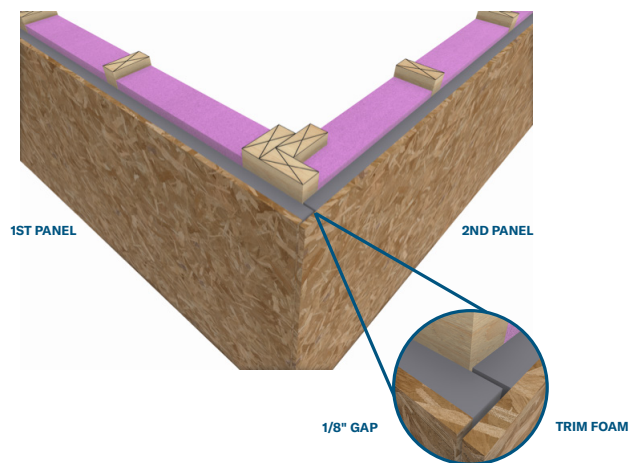
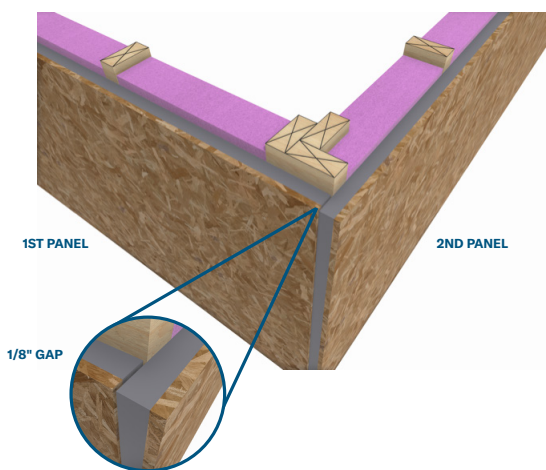

Visit [LPCorp.com/NovaCore](http://LPCorp.com/NovaCore) or call 888-820-0325 today!